

a
great
place
to
be!

MACON PLAZA



DOWNTOWN CAÑON CITY STRATEGIC PLAN

April 2012

2. Develop a Downtown streetscape “design manual” to establish a palette of durable street furnishings and materials that ensure a cohesive identity and maximize the life-cycle of the furnishings that are approved by a Downtown organization and the City.

3. A key element of the strategic plan should be the re-establishment of a strong central gathering place Downtown. A “central square” or plaza should be created to provide for public gatherings and activities and connect the surrounding residential neighborhood with Downtown. The central square should include, among other things:
 - a. A strong pedestrian orientation both internally and as a linkage between Downtown and nearby residential uses;
 - b. A hub of neighborhood recreational activity for nearby residential uses;
 - c. Children’s programs that build off proximity to the library and arts center;
 - d. Public art and art walk/park that infuses modern and historical influences of the community and that serves as an anchor attraction for Downtown;
 - e. Children’s play structures;
 - f. Programming for festivals, performances, farmers markets, and other events that intend to draw people Downtown;
 - g. Water features; and
 - h. Open gathering space

4. Investigate the potential for a Community and Recreation Center or similar facility that is capable of attracting residents Downtown. The intent should be to reuse existing underused buildings. Possible locations include:
 - a. The Garden Park High School building, if the School District discontinues the use of the building;



Pedestrian-oriented

Central square or plaza

Strong central gathering place

**Programming for festivals and events to draw
people downtown**

Anchor attraction for downtown

Water feature

Public art and art walk

Children's programs

Hub of recreational activity

Build off proximity to the Library

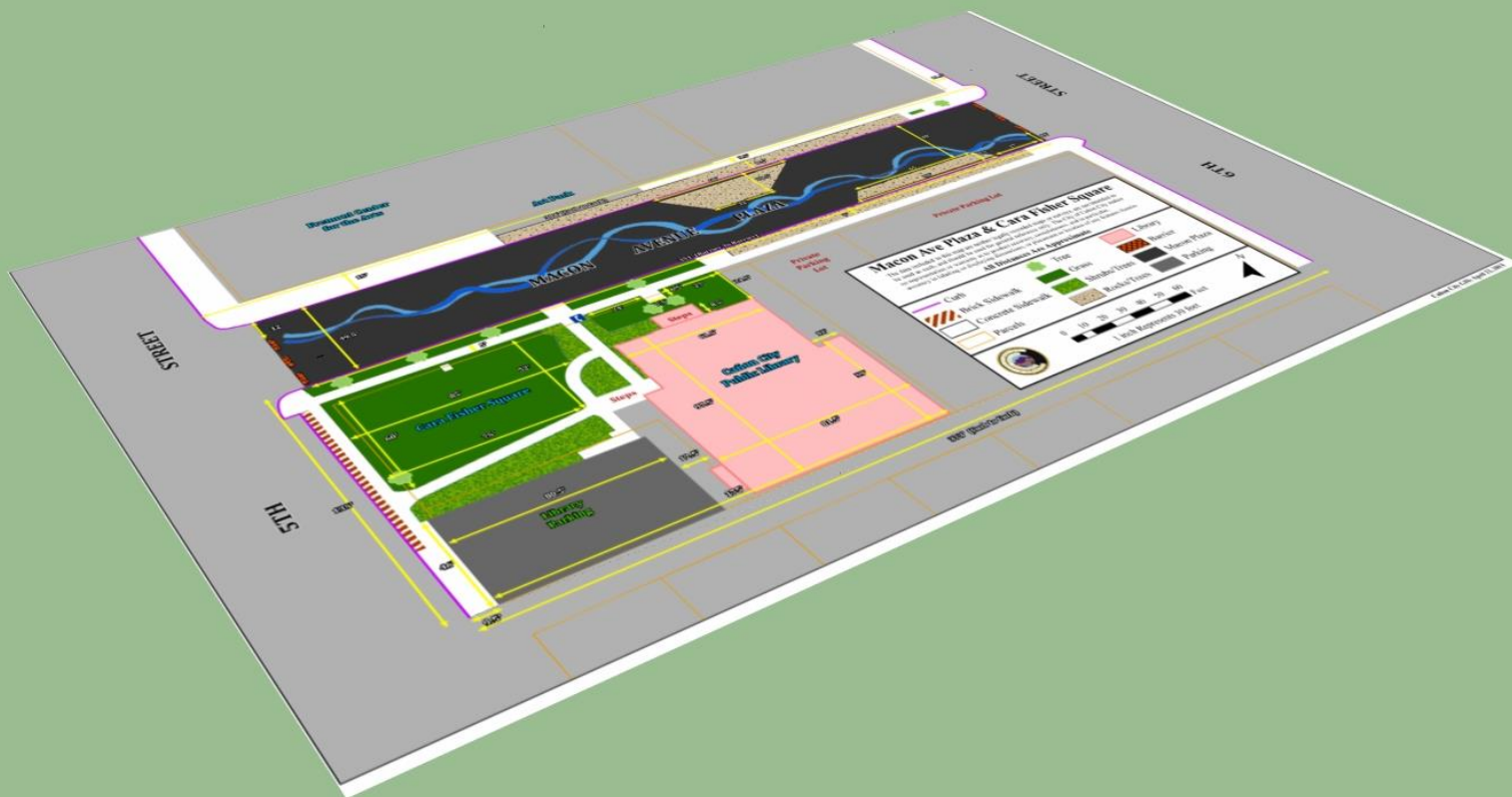

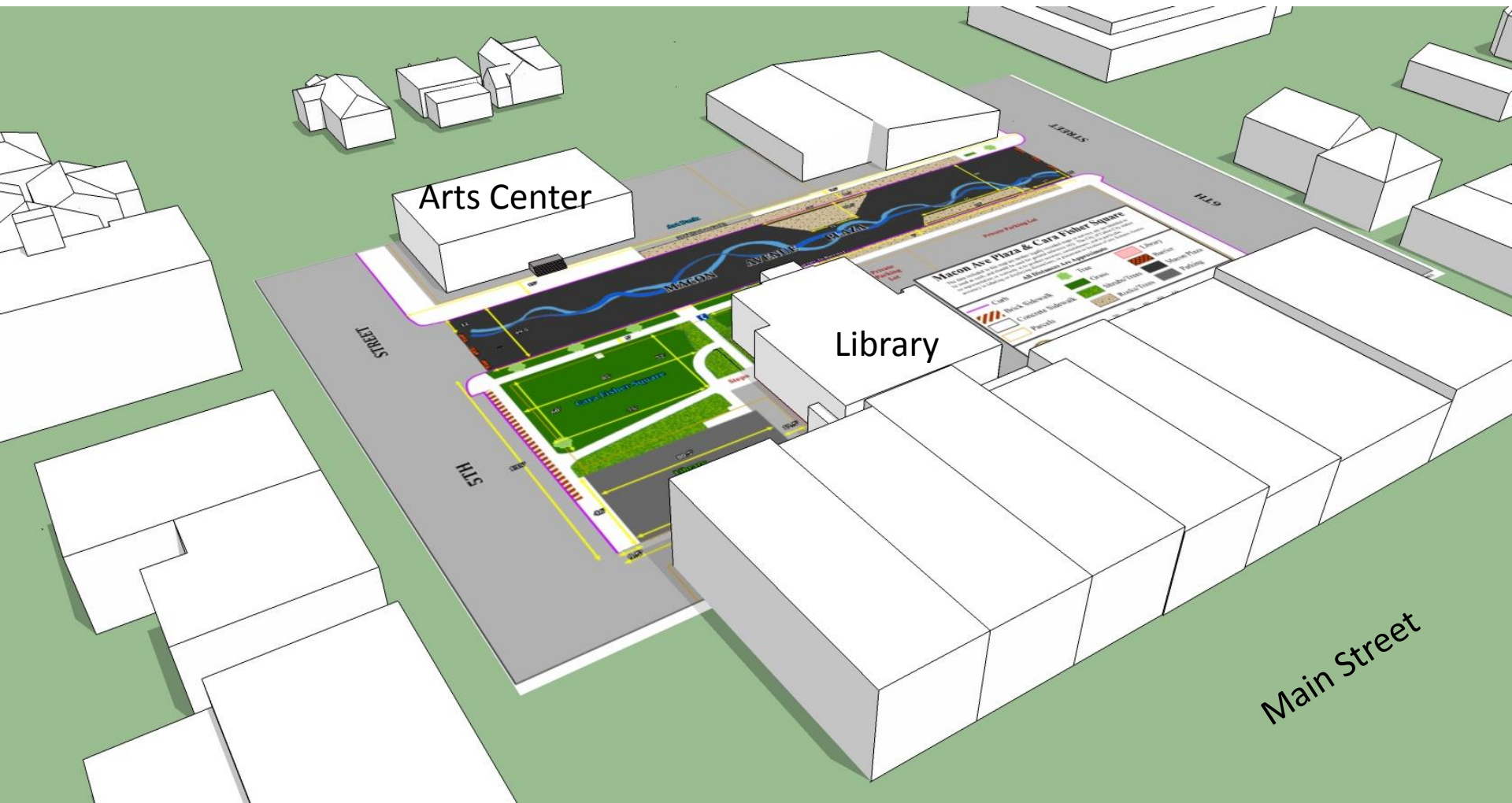

Arts Center

Library

Main Street



