

**Marsh writes to Felch that the connection has been made on Sk. 11. Felch is to keep remaining pieces free from frost.**

Department of the Interior, United States Geological Survey

~~Washington,~~ New Haven

Jan 15<sup>th</sup>, 1887

Dear Mr. Felch,

I have been absent for the last ten days, and find yours of the 1<sup>st</sup> here on my return.

I enclose check as usual, and will write again soon. We are getting on well with Sk. 11, having made the connection all right. Keep all pieces till spring where frost cannot hurt them.

Yours Truly  
O. C. Marsh

**Marsh writes to Felch that he needs a sketch of how the groups were in the quarry, especially in relation to Sk. 11. He can only lay out a section at a time and needs an overall idea to complete the plates for his volume.**

Department of the Interior, U. S. Geological Survey  
~~Washington, D. C.~~, New Haven

Jan 19<sup>th</sup>, 1887

Dear Mr. Felch,

We are working on Sk 11, but as we have only room to lay out one point at a time we find some trouble.

What we seem to need is an outline sketch of how the groups lie, and about how the beast Sk 11 runs through them. We have got all right down to the base of the tail, (from the head) but we need some rough guide sketch to show how the tail itself goes on and where the rest of the femur and adjoining hind leg has gone to. We shall make it all out later, when we unpack all the boxes, but I am very anxious to get out the tail and one hind leg as soon as possible, as every hour is precious in making plates for the Volume. Help us if you can.

Yours in haste  
OCM.

**Felch, due to illness, requests his daughter, Sadie, to write to Marsh concerning a request from for information on Sk. 11.**

Garden Park, Colo.  
Jan. 23<sup>rd</sup>, 1887.

Prof. Marsh  
Dear Sir: —

Father recd. your letter with check last evening and today yours of the 19, inst with inquirer relative to Sk. 11. and being quite ill requests me to say as soon as he is able he will look up the matter for you.

You will also find inclosed rec'pt. for money sent.

Sincerely,  
Sadie E. Felch.  
[in behalf of M. P. Felch ]

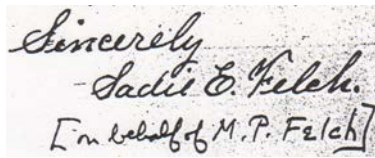

Sincerely  
- Sadie E. Felch.  
[in behalf of M. P. Felch]

**Marsh writes to Felch that he is sorry to learn that he has been ill. They have the Sk. 11 blocks laid out now and will begin to expose the bone. More boxes have arrived safely.**

Department of the Interior, United States Geological Survey  
~~Washington, D. C.~~, New Haven

Feb 4<sup>th</sup>, 1887

Dear Mr. Felch,

I was sorry to learn from your daughter that you are not well, and hope you are now all right.

We have got most of Sk 11. together, and hope soon to cut it out so that we can see it.

The 31 boxes came in good order.

Yours Very Truly  
O. C. Marsh

**Marsh writes to Felch that he has made room to lay much more of the blocks out and that Felch's diagram helped. He hopes to find a hind foot and to get the position of the plates and spines.**

Department of the Interior, United States Geological Survey  
Washington, D. C., New Haven

Feb 10<sup>th</sup>, 1887

Dear Mr. Felch,

Your letter and diagram helped us out, and we have all together now but Gr. 20. I made room at last for it all.

I am very anxious to find the hind feet (or one of them), and also to get the position of the plates and spines, and hope all will come clear when we have cut out the tail, and what is near it.

Hoping you will soon be better.

I remain  
Yours Truly,  
O. C. Marsh



[ed. This sketch appears on the back of the letter. There is no apparent connection to the letter and may be Felch doing a quick map for someone or a loose quarry sketch as a preliminary to locating the bones for Marsh.]

**[Ed. Note: The first two pages of this letter are missing.] Felch writes that he has been ill for five weeks with attacks and nearly died. He wishes to receive an extra remittance for the winter and lists reasons of previously un-reimbursed expenses.**

Feb 21<sup>st</sup>, 1887

P.S.

3

I am having rather a serious time this winter – and it has been almost five weeks since I was out – have had two attacks since my last in one of which I came near going off.

My physician hopes to get me out as soon as the snow melts off and the weather gets a little warmer

Now I wish to know if it is asking too much to make me some allowance for these winter months – and in considering the matter please take into account among other reasons the following facts.

(1) That the \$50 allowed last winter for improvements only covered about half the actual cash outlay and that some two weeks work by myself and one hand was done in March and no account of the time made. [Feb 21<sup>st</sup>, 1887]

(2) That my lumber cost me from 30 to 50 pr cent more than estimated, or ever cost before.

(3) That I had washed away by flood over 30 dollars' worth of lumber – selected for boxes and that as long as I took all of the ordinary precautions for safety – I should not be held to lose it all. (I had a large lot of slabs and lumber besides this lot washed off of my own).

(4) Though I only charged time up to the 15<sup>th</sup> of Dec. I worked into the first week in Jan. to get things in shape to leave safely – and since – on every fall of snow have had to send a man to clear it off from exposed portions – also to keep a general lookout for the safety of the property etc – all of which takes – care time and expense for me – and all of which is hereby respectfully submitted

M. P. Felch

P.S. Haven't touched a pipe – tobacco – or coffee for almost five weeks – M. P. F.

**Marsh writes to Felch that he is sorry to hear that things are going badly for Felch personally and that he hopes he is soon better. He sends the March payment early.**

Department of the Interior,  
United States Geological Survey, Division of Vertebrate Paleontology  
New Haven, Conn.

March 10<sup>th</sup>, 1887

Dear Mr. Felch,

I was very sorry to hear from your last letter how unfortunate you have been, and I wish it was in my power to make it all up to you. I will do all I can now, and perhaps may be able to do more later when I see how my accounts for the year come out.

I enclose a check for \$75. for the month of March, which you may use any time after the date of it, and in the meantime send me the vouchers for it.

I hope your health will soon be better, and that when the flowers bloom in the spring you will be yourself again.

Yours Very Truly  
O. C. Marsh

**Felch writes to Marsh thanking him for the \$75 check and explains his heart problem which has deteriorated this last winter. He would like to spend another winter in the south, permanently if it helps and asks if the quarry is to be worked this summer so he can make plans.**

Canon City, Colo.  
Mar. 19<sup>th</sup>, 1887

Prof Marsh  
Dear Sir

Yours of the 10<sup>th</sup> with vouchers – and check for \$75.<sup>00</sup> I received all right – am greatly obliged – as it will help make up where I ran behind so much last season.

Since the warm weather set in I have gained strength fast - but hardly expect to ever be as well as I have been – for I have a heart lesion that in the past year or two has become organic = mitral regurgitation and dilation . =

I want to try and shape matters so that if I am alive and able = to go back near the sea-coast another winter – in Georgia or Florida – and see if it would help my case any – and if it would to make the change permanent.

Do you intend to have the quarry worked as usual this season or not?

I would like to know soon – so as to make calculations on what to do – for I must be at something soon to make up for my long spell of enforced illness and expense.

Respectfully Yours  
M. P. Felch



**Marsh writes to Felch that he is sorry to hear is still ill and outlines alternate plans for beginning work in the quarry as Felch becomes able.**

Department of the Interior, United States Geological Survey,  
Division of Vertebrate Paleontology  
New Haven, Conn.

March 25<sup>th</sup>, 1887

Dear Mr. Felch,

Yours with vouchers has just come to hand.

I regret extremely to learn of your ill health, and hope the warm weather will soon make you well again.

About work I can only say now that you may begin as soon as you are able. If you can start in April 1<sup>st</sup>, as before, I will allow \$150. as last year. If you think May 1<sup>st</sup> would be better, all around, to begin, regular work. I will allow you \$75. for April as I did for March, and \$150 from May 1<sup>st</sup> on.

Yours Very Truly  
O. C. Marsh

**Felch writes to Marsh that they are ready to go back to work. He may later want additional funds for lumber.**

Canon City, Colo.  
April 2<sup>nd</sup>, 1887

Prof. Marsh  
Dear Sir

Yours of Mar. 25<sup>th</sup> found me in pretty fair trim, and ready to go to work – though if it had not been for the fact that I had got to set a good man at work at once, or lose him for the season I would not have set in before May 1<sup>st</sup>

He has worked on the quarry – (two years since) is a good steady hand and with him I can do good work.

The terms are fair – but in case we should strike any good streak of luck as on the first years' work I might wish you to make a little extra allowance on some of the supplies – especially the lumber bill which gets away with all my margin of profits.

Yesterday we uncovered where work was left off last season – and we found everything all right and we can go on with the work and have it in shape to connect as well as formerly.

Please to excuse this small paper – was entirely out before I knew I was short.

I will write again as soon as I can obtain some of the “regulation” size.

Respectfully Yours  
M. P. Felch

P.S.  
My wife sends a few sunflower seeds – to try in Conn. soil.

**Felch writes to Marsh to acquaint him with present quarry conditions. He asks advice on whether to get all the fossils, going slowly, or to put the unimportant aside and press on for something complete. He discusses the apparent lack of good fossils recovered in the previous seasons work as his reason for suggesting the quick approach. He includes a drawing of the quarry showing what little is left to be worked.**

Canon City, Colo.  
April 10<sup>th</sup>, 1887

Prof. Marsh  
Dear Sir

In regard to conducting the work this season so as to get the best results for time and money spent – I may need some advice from you = but first you will have to know the situation and condition of the quarry as we find it on starting in – and this I will try to give as clearly as possible.

The better to understand what there is to do, I send an outline showing the little ground we have left, that is stripped off for working – ground that will not last two of us more than two months to work out if we pursue the methods of working as formerly.

This unworked strip is all to the right of where Sk. 11 lay – and is some 30 feet long, from four to seven in width – and will average two and one half feet in depth.

It is in two separate layers – some large bones = among others a scapula that we are at work on now in the upper one = and the lower one being crowded full of bones just back of, and connecting with group No 20 and 21 sent last fall.

Now what I wish to know is – whether I shall continue on as we have for the past two seasons – taking everything clean as we go – making group join group as fast as removed or to push on ‘till we find some continuous skeleton like No. 4 or 11 – throwing all else aside and working out that of most value?

My reasons for this is from the fact that probably four fifths of our time have been spent during the past two seasons in working out material that does not amount to much – unless that which is comprised in groups 16 – 20 & 21 – taken out with Sk. 11 last year should prove of value on being worked out.

To work a quarry in this way is terribly slow and tedious – and but little ground can be gone over in one season – but what is gone over is thorough and nothing lost = whereas by the methods adopted the first year – we can get over four times the ground – and strike the chance of getting a greater variety of material – though always at a risk of more or less damage.

I want to do the best all round – and get in as far as possible – for I believe as we go in East the material will be better and more of it – and we should find more skulls in that direction as I do think some are due, and not far away.

Briefly then to sum up with – shall we keep along as usual or – go ahead till we find something of special interest?

Under where we are at work and in the lower layer of bones is more of the material such as will be found in groups 20 & 21 – connected with and continued on from those two groups; these we had proposed to work out so as to keep the connection – for I think when you work them out if the “hollow legged” animal there is not of interest – that there are foot bones enough to pay for saving. I rec'd the interesting paper on Jurassic Mammals – should have made a thorough hunt this winter in the Cretaceous for mammals had I not been sick.

Respectfully –  
M. P. Felch

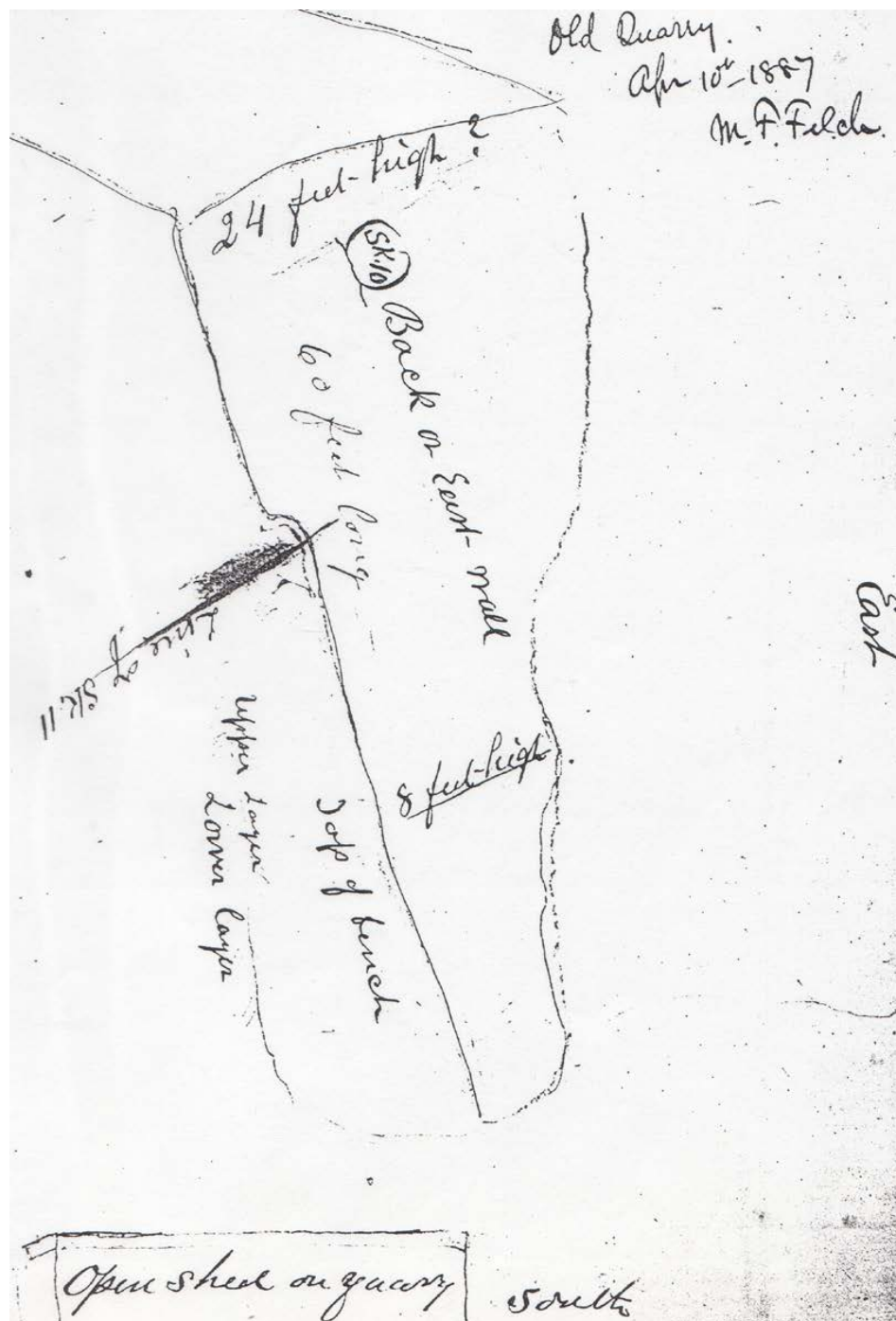

Old Quarry Apr 10<sup>th</sup>, 1887  
M. P. Felch

24 feet high?      60 feet long      8 feet high  
Sk. 10 Back on East Wall      Line of Sk. 11  
Top of bench      Upper Layer      lower layer  
Open shed on quarry

**Marsh writes to Felch that he wants the remaining parts of the skeletons he has started on, and a possible carnivore skull. This is preferable to prospecting new ground. He thanks Mrs. Felch for some sunflower seeds.**

Department of the Interior, United States Geological Survey  
~~Washington, D. C.~~, New Haven

Apr 15<sup>th</sup>, 1887

Dear Mr. Felch,

Yours of the 10<sup>th</sup> inst. about working the quarry is at hand.

I can only say now that I am anxious to get the remaining parts of the skeletons now partly out, rather than to strike new ones. You better save everything as you go, for the present.

I hope the East end will prove rich, and as the bank is low there, I would keep in that region rather than prospect over new territory.

I believe you think the skull of that big Carnivore is in the bank further west. What are the chances of finding that by digging? I want another Carnivore skull very much.

We find more and more Carnivore bones mixed with Sk 11, but have not yet got onto the latter half of the tail.

Please thank Mrs. Felch for those sunflower seeds. I shall plant them on my place.

Yours Truly  
O. C. Marsh

**Felch writes to Marsh that the weather has turned stormy and there are no finds of great interest. He gives requested information on where to look in the blocks from last year for parts of a carnivore skull.**

Canon City, Colo.  
April 24<sup>th</sup>, 1887

Prof. Marsh  
Dear Sir

I have put off writing a few days, in hopes that something of interest might turn up to report = but we find only about the same condition of things as usual – only that our long continued warm and dry weather has given place to a stormy one – raining or snowing now almost every day.

I will continue on as you suggest = as usual = and save everything as we go – but some of this upper layer that has been exposed to the weather so long is very rotten and hard to do much with.

We have found some two or three large vertebrae – lumbar or caudals = and a large illium in this upper layer besides the scapula mentioned in my last. The vertebrae will come out all right – also the scapula – but the illium is going to be hard to remove as it very rotten and is crowded in with other bones.

After this top is off, the lower strata of bones that match up to group 20 & 21 of last year will come out better – and I hope to find there something of more interest.

In regard to the skull of the big carnivore – I think if some of it is not found along side of the tail in groups 16 or 20 it is somewhere ahead of us in wall where considerable stripping has to be done to reach it.

There were some singular looking bones in the same block = and in the blocks near where the portion of jaw, (right pre-maxillary) is seen in Gr. 20 – and when you come to it you may possibly find some of the skull of this carnivore – or more of the jaw.

I pushed into the wall as far as I could last fall – in the direction where I thought this skull should be found, for we had found so much of the skeleton alongside Sk. 11 that I felt sure we should get a good specimen if fortunate enough to run across the skull.

I shall make a special effort again – when we come to the next stripping off to find it.

I enclose the statement for Apr. so that if you wish to collect on vouchers = monthly = as last year you can send them on in season.

I have made the statement the same as last year – so that if you can make me some allowance at the close of the season for lumber extra – above 150 dollars that you will not be behind.

Respectfully Yours

Transcribed at the Garden Park Paleontology Society's Dinosaur Depot Museum, Cañon City, Colorado.  
Original material housed at the Marriott Library, Special Collections Division; University of Utah, Salt Lake City.

M. P. Felch

Canon City, Colo.  
Apr 30<sup>th</sup>, 1887

Prof. O. C. Marsh  
To M. P. Felch      Dr.

To work on fossils – self – help – team and expenses at one hundred and seventy dollars pr.  
month – from Apr. 1<sup>st</sup> to Apr. 30<sup>th</sup> inclusive \$170.<sup>00</sup>



**Marsh writes to Felch that they cannot find more of the Sk. 11 tail after the break. They are finding Morosaurus, part of a carnivore skull instead and various other things.**

Department of the Interior, United States Geological Survey  
~~Washington, D. C.~~, New Haven Conn.

Apr 27<sup>th</sup>, 1887

Dear Mr. Felch,

Enclosed find voucher for April, which return soon.

We cannot get on to the Sk 11. (Stegosaurus) after the break in the tail, but find instead bones of a Morosaurus, part of Carnivore skull (in Gr. 20) and various other things.

We can find nothing resembling spines or small tail vertebrae. Where have they gone?

I want another Carnivore skull very much, so look out for one.

Yours Truly  
O. C. Marsh

**Felch writes to Marsh with requested information on the tail of Sk. 11 which should be in Group 20. if it not there it is still in the quarry or lost. He is still trying to find a carnivore skull and will look in the quarry across the gulch if he has no luck. Brown found dorsal vertebrae and foot bones there.**

Canon City, Colo.  
May 2<sup>nd</sup>, 1887

Prof. Marsh  
Dear Sir

Yours with the vouchers for April I received yesterday – and return them with this.

About the tail in Sk. 11 if not all found in Gr. 20 - the rest must be still in quarry or lost.

I know it went clear thro' the left end = even to the last blocks on the backside of Gr. 20 – although toward the last it seemed to be displaced somewhat.

In the wall where we left off work there was no signs of there being any more – and we supposed it to be in what was sent on in Gr. 20

There was one pair of spines certain in Gr. 20 – also a plate – both coming near together in about the 2<sup>nd</sup> or 3<sup>rd</sup> run of blocks from the front side of the group – and though this was the last of the plates noticed I thought there were more of the spines farther back – but may have been mistaken.

I am in hopes to get you a Carnivore Skull before the seasons work closes – if not here back of where we are now at work will try a week or two on the other side of the gulch where Brown worked, for he struck on to several dorsal vertebrae and some foot bones of a Carnivore – of a type different from either Ceratosaurus or Allosaurus.

Respectfully Yours  
M. P. Felch

**Felch writes to Marsh that they have found interesting leg bones, seemingly in a natural position. They also have a new find of leg and foot bones, some in place, which he hopes will help Marsh with “an unsettled point with the feet of Sauropoda”.**

Canon City, Colo.  
May 12<sup>th</sup>, 1887

Prof. Marsh  
Dear Sir

Since my last we have been at work on something of more than usual interest to us.

First we struck in just back of where I took out some pelvic bones last fall – sent I think in “Gr. 44” = on the right and back of Gr. 21 – Sk. 11 = and we here found three leg bones, two being the tibia and fibula – lying in natural position – with several other bones lying alongside – one of which proved to be a sternal bone.

Having in mind what you told me last season when you were here about an unsettled point in regard to the feet of Sauropoda – I made up my mind to keep a sharp lookout here = knowing that ~~the~~ we used to find the feet here in the “East End” in place better than anywhere else.

On reaching the distal ends of the tibia and fibula (4 feet long) we found first in place, a large bone – probably astragalus – next – five metatarsals - the 3” – 4” and 5” in regular order – but Nos 1 and 2 in place but setting partly on end – attached to the distal ends of all but No. 5 – were the next row of tarsals – one of these No 3. is outlined in the sketch enclosed [not found with the letter]. Next came three well defined claws – and some small bones – also shown in sketch – which were probably in place of claws.

We have in all eighteen (18) bones of the foot, and I can make a diagram to show the exact position of all –

Most were connected – as will be found when you work them out – but the large claw and two that I called “terminal bones” lay but an inch or two away from the ends of the 2<sup>nd</sup> row of tarsals.

I think we have found all of the bones of one foot ~~foot~~ but the calcaneum = that there are but one row of bones between the metatarsals and claws = and that the two outside claws – are claws - without much shape or form however.

I hope you will find them to settle the point – for we have taken a good deal of pains to get them out of very difficult ground all being bedded in a soft putty like marl – very rotten while the upper portion was in a cement like rock without rift or seam and all had to be worked out separately with fine pointed tools.

The sketch I send is only a rough outline made by laying each bone down on the paper and drawing a pencil around it – but it gives the size and shape very well

On Sunday if I can get some light paper will make a full sized diagram with exact position of all and mail it to you -

These leg bones are the longest we have ever found in the quarry – and I have thought may belong to *Diplodocus* – and if so you have the ischium and some other bones of the same animal sent last season.

Shall I receive a remittance by the 20<sup>th</sup>?

On the first of April we “turned over a new leaf” paying down for everything bought – to see if we could not keep nearer even – and the plan works well so far – as we find a saving in making purchases – but last month and this, in starting in we have a little more than the average to pay out and have about run out of money – though I had some 150 dollars come in for hay and other produce sold – besides what you sent.

Respectfully Yours  
M. P. Felch

**Marsh writes to Felch that they still have no more spines or vertebrae of Sk. 11 in block 20, and fears they are lost.**

Department of the Interior, United States Geological Survey  
Washington,

May 12<sup>th</sup>, 1887

Dear Mr. Felch,

Enclosed find check for April, which please acknowledge.

We can find no more vertebrae or spines of Sk 11 in 20, and I fear we have lost them.

Hope you are having good luck.

Yours Truly  
O. C. Marsh

**Marsh writes to Felch that he needs clarification on two points concerning a possible Diplodocus hind foot. He asks the weight of this, as he may want it by Express. He sends an oath (United States Geological Survey) which Felch needs to swear before any U. S. official with a seal.**

Department of the Interior, United States Geological Survey  
Division of Vertebrate Paleontology  
New Haven, Conn.,

May 18<sup>th</sup>, 1887

Dear Mr. Felch,

Your letter about the hind foot of Diplodocus? interested me very much, and I hope you can make sure on one or two points.

(1) The number of joints in each toe between the metatarsals and claws. You say there is only one, but yet you find 18 bones in the foot.

(2) The exact form of the claws (or bones representing them) on the 4<sup>th</sup> and 5<sup>th</sup> toes.

Both these points are of great importance.

If the foot had not been so large, the best thing would have been to try to keep all in position, with plaster etc. Even if it broke up in coming, we could get the pieces together. I have 50 feet of Dinosaurs in pieces, but only imperfect ones still in the matrix. Of all the feet from your wonderful quarry I have not one with more than two thirds of the bones except of that big carnivore, of which both hind feet are nearly perfect.

How much would the present foot weigh? I may want it sent on by Express. Please keep it sacredly by itself, and while it is fresh in your mind, make diagrams and mark each bone so that we can get it together again here, as I may want to figure it as it lay.

I enclose a blank oath which all on the Geological Survey are expected to take as a matter of form. You can swear it before any U.S. officer who has a seal, and return it soon as convenient.

Hoping you will soon strike another foot.

Yours Truly  
O. C. Marsh

**Felch writes to Marsh that the check has been received. He will soon write fully about more stripping off.**

Canon City, Colo.  
May 21<sup>st</sup>, 1887

Prof. Marsh  
Dear Sir

I came in to town this morning and find yours with check enclosed = comes in a good time and am greatly obliged.

Please find receipt enclosed.

We are getting along very well – but shall have to go to stripping soon – of this will write more fully soon.

Respectfully Yours  
M. P. Felch

Canon City, Colo.  
May 21<sup>st</sup>, 1887  
\$150.<sup>00</sup>

Rec'd of Prof. O. C. Marsh for work on fossils – self – help team & outfit – for the month of April 1887 one hundred and fifty dollars.

M. P. Felch

**Marsh writes to Felch that he is very interested in the hind foot. He has also found one metatarsal of Sk. 11 at New Haven.**

Department of the Interior, United States Geological Survey  
Division of Vertebrate Paleontology  
New Haven, Conn.,

May 22<sup>nd</sup>, 1887

Dear Mr. Felch,

I enclose voucher for May to save time. I will perhaps telegraph on receipt of your letter about that hind foot, which interests me much.

We have found one metatarsal of Sk. 11, and hope more may be near.

Yours Truly  
O. C. Marsh



**Marsh writes to Felch that he thinks, from Felch's notes and sketch, that all of the hind foot is there and wants it at once. The rest of the material should be boxed and sent when he reaches the wall and he can then put on a man to remove more overburden.**

Department of the Interior, United States Geological Survey  
Division of Vertebrate Paleontology  
New Haven, Conn.,

May 27<sup>th</sup>, 1887

Dear Mr. Felch,

Yours of 22<sup>nd</sup> with diagram is at hand. I think you have all of that big foot, but am not yet quite sure how the bones go on some of the toes. We can probably make it all out when we get them before us here, with aid of your full notes and sketches.

About the work at Qu. 1, I think you better box up and send on all the material on hand when you get up to the wall. We need the foot at once, and the other bones may help us out.

After July 1<sup>st</sup> you may put on another man for stripping, but I must keep expenses as low as possible till that time. I fear I shall have run considerably (over) as it is.

Yours Truly  
O. C. Marsh

P.S.

You may box, as before, with numbers 1, 2, 3 etc. and continue the numbers in your second shipment next fall. Put on each box U. S. G. S. (not Yale College) and send through the Quartermaster Dept. whenever ready.

**Felch writes to Marsh that they are about ready to ship as requested. He also wants to get help and strip off before the worst of the heat. He is unsure if anything else belongs to Sk. 11 but will know after exposing more of the bone layer.**

Felch [Note attached to the top of the letter.]  
June 6<sup>th</sup>, 1887  
Spines of Steg in pairs  
Allosaurus skel.

Canon City, Colo.  
June. 6<sup>th</sup>, 1887

Prof. Marsh  
Dear Sir

We have all out clean up to the wall now – and are getting a lot ready for shipment as you directed in your last.

In what we have removed, there is nothing certain that we can identify as belonging with Sk. 11 – though at the point where it left off last season we carried it into the wall farther than any the rest of the work – and in this lot there was but a short distance (little more than a foot) of ground more at that point that we could get at before striking the wall again.

In all of the very large group that we have just removed – that came just back of where *Grs.* 20 & 21 lay – we have found spines scattered all the way along – in one or two places coming in pairs – and at one point there are two vertebrae that may prove on working out to belong with Sk. 11

All of these points are fully located on diagram of the group.

We can also trace the big carnivore – and are working toward his head – have found the coracoid – joined to the scapula which is in the wall ahead of us.

We shall probably have some eight or ten boxes to send in this lot – and we will get them off as soon as possible marked and directed as you ordered

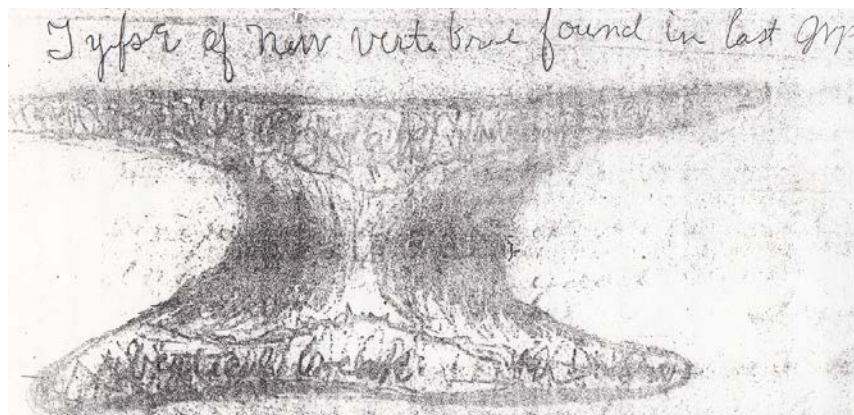

Type of new vertebrae found in last grp [writing has been traced by someone with a fine pen]  
Vertical break

We shall be ready to commence stripping off in a week or ten days if we have good luck

I wish to get as much done as we can before the extreme hot weather sets in – for the open exposure in our quarry of white rocks makes it almost like an oven to work in at stripping off – and it is hard to find men who will work at it in hot weather.

If I put in another man this month, for half a month, we can carry it over until another month in the account – will do the best I can toward economy and at the same time push on the work to the best advantage.

I suppose you have received the vouchers and the Oath.

There are no Federal officers nearer than Pueblo and I had it sealed by the Dist. Clerk of Court – who takes evidence in land cases and who I suppose is competent to do this.

I was in town the day that I received and ret'd the vouchers and did not have time to make out a statement to send along with it – but I suppose it will make no difference – as the receipts for the money will do as well

Respectfully Yours -  
M. P. Felch

**Marsh writes to Felch that he is very glad they have found spines. The sketched vertebrae must be Allosaurus, look out for the fore feet and skull.**

Department of the Interior, United States Geological Survey  
Division of Vertebrate Paleontology  
New Haven, Conn.,

June 12<sup>th</sup>, 1887,

Dear Mr. Felch,

Enclosed find check for May.

Am very glad you have found those spines in pairs, and hope they will keep in position till they get here.

The vertebrae sketched must be Allosaurus, or a nearly allied Carnivore. Look out for the fore feet and skull. Both become important now we know Ceratosaurus.

You may get that extra man at once, as you suggest, and arrange pay as proposed. Can't you get a shed or tent over the quarry during the great heat of summer? It was very hot even in Sept. I remember.

Yours Truly  
O. C. Marsh

**Marsh writes to Felch that government funds have run out but he is paying out of his own funds. More boxes have arrived.**

Department of the Interior, United States Geological Survey  
Division of Vertebrate Paleontology  
New Haven, Conn.,

July 17<sup>th</sup>, 1887

Dear Mr. Felch,

I enclose a check for \$150. as I know you need the money. The Govt funds ran out, and I have to pay this out of my own pocket.

The boxes came in good order. That foot is not quite complete, I fear.

Yours Truly  
O. C. Marsh

**Felch writes to Marsh that he has shipped 14 boxes and says he will put on an extra man to start stripping off tomorrow.**

Canon City, Colo.  
June 19<sup>th</sup>, 1887

Prof. Marsh  
Dear Sir

Yours of the 12<sup>th</sup> • with check for May came yesterday – for which please accept thanks, and the receipt enclosed.

We had the boxes shipped on the 17<sup>th</sup>, all in good condition.

There were 14 in all – three wagon loads – between 4 and 5 thousand pounds – somewhat more than I expected before packing.

I will send on the list of contents of boxes soon. Shall begin stripping off tomorrow, and put on another man.

Respectfully Yours  
M. P. Felch

Canon City, Colo.  
June. 18<sup>th</sup>, 1887

\$170<sup>00</sup>

Rec'd of Prof. O. C. Marsh one hundred and seventy dollars – for work on fossils, self – team and outfit for the month of May 1887

M. P. Felch

**Marsh writes to Felch asking if there are any more phalanges and asks him not to use on the bones.**

Department of the Interior, United States Geological Survey  
Division of Vertebrate Paleontology  
New Haven, Conn.,

July 21<sup>st</sup>, 1887

Dear Mr. Felch,

Enclosed find voucher for July, which return soon.

Of that foot I can find no phalanges exceeding 3 to each toe, and not that. Some must be missing. Are you sure none others however small lay near?

Don't try *verinition* on bones. We can't get it off our fingers.

Yours Truly  
O. C. Marsh

**Felch writes to Marsh that he wishes he had known about the funding problems sooner and he will let his extra man go. They are finding more of Sk. 11 and will work on until they hear from Marsh.**

Canon City, Colo.  
July. 24<sup>th</sup>, 1887

Prof. Marsh  
Dear Sir

Yours of the 18<sup>th</sup> with check for June payment came yesterday

Was sorry that we could not have known sooner how the funds would hold out – we could have made different arrangements about work – should not have hired an extra man or have stripped off so much ground but we could not have done much different about stripping, for in order to find what bones were supposed to be in that direction we had about so much to take off to get to them

As it is I shall turn off my extra hand tomorrow and in regard to future work you must write me soon just what to do.

If you wish to suspend work altogether by Sept. 1<sup>st</sup>, I can do so 'tho' in hiring my help – I agreed to give six months work from April 1<sup>st</sup> as I did not care to work myself longer than the middle of October on account of my trouble which comes on worse as cold weather comes on.

There will be due me on July account two hundred dollars – with the extra man from June 21<sup>st</sup>.

I pay him 35 dollars for the time and charge fifteen for board for the time – and could not make the bill less without loss.

We had but just got well through stripping – and commenced work again on the bones – finding another end of a tail of Brontosaurus when we got your letter

Around and under this tail appear to be many other bones – and to the left = north = of these are the bones continued from Sk. 11 and the large group just sent on.

While waiting to hear from you we will work ahead as far as we can on these to see if anything of importance turns up.

Enclosed find receipt for money sent

Respectfully Yours  
M. P. Felch

Canon City, Colo.  
July 23<sup>rd</sup>, 1887



Transcribed at the Garden Park Paleontology Society's Dinosaur Depot Museum, Cañon City, Colorado.  
Original material housed at the Marriott Library, Special Collections Division; University of Utah, Salt Lake City.

\$170.<sup>00</sup>

Rec'd of Prof. O. C. Marsh the sum of one hundred and seventy dollars – self – team and outfit  
for work on fossils for the month of June 1887.

M. P. Felch

**Marsh writes to Felch that he needs to move whatever bills possible to July due to fiscal year problems, "the govt ran out of money".**

Department of the Interior, United States Geological Survey  
Division of Vertebrate Paleontology  
New Haven, Conn.,

July 30<sup>th</sup>, 1887

Dear Mr. Felch

Yours with vouchers rec<sup>d</sup> today.

The Govt money ran out for the month of June, as end of the fiscal year. July funds are all right and so for the rest of the season, so please put all you can over July 1, and push on the work.

I had to pay all June bills, and accounts out of my own pockets, but for July I shall have the U. S. behind me.

Yours in haste  
OCM

**Felch writes to Marsh that he has not received the full payment due and outlines arrangements for this and to get Marsh reimbursed for what he paid out of his own pocket. They have found the mate to the Diplodocus femur that he and Williston found in 1877. New finds cause him to believe that Skull No. 3 belongs to this Diplodocus.**

Canon City, Colo.  
Aug. 7<sup>th</sup>, 1887

Prof. Marsh  
Dear Sir

Yours of the 1<sup>st</sup> I received in due season.

The vouchers you sent for July did not cover the amount due me for that month, but to save you time I concluded to send them signed and have it made right on this month's account.

I am still behind, having had more than usual to pay out during the past month – and if you can send a check by the 20<sup>th</sup> I can nearly get paid up again.

For this month you must send vouchers made out to cover past dues – and if you wish to make up what you paid out of your own pocket – I will sign for enough to make you whole again.

We are getting along well – have been working ground on the extreme South end – and near where we done work in June 1883 – and the first year (1877)

There is not much here = most of the bones being water worn and badly broken up – but we have found the mate to the big Diplodocus femur that Williston and I found in 1877 – also part of the tail = some of which has been found at various times and has been sent on before = also have found other leg bones and some foot bones and vertebrae.

With this last femur is a bone that we think is either a part - pubis or ischium will send an outline of it the next time I write.

In finding these last bones of Diplodocus it makes it quite certain to me - that skull No. 3 belongs with this skeleton.

I will map out and measure – and describe the different parts of this as it has been found if the point is of any importance.

We have a few feet more of this ground to work off before we can get to that we want most – was obliged to work it in the way we have – in order to work to advantage – and also so as to try and shape things so that our groups will not be so large as some we have made.  
We hope to find something of more interest after we get a little further along - but we have to work the ground as it comes good or bad.

Respectfully Yours

Transcribed at the Garden Park Paleontology Society's Dinosaur Depot Museum, Cañon City, Colorado.  
Original material housed at the Marriott Library, Special Collections Division; University of Utah, Salt Lake City.

M. P. Felch

**Note attached to bottom of letter, apparently upon receipt in New Haven.**

Felch Aug 7<sup>th</sup>, 1887

Wants funds by 20<sup>th</sup>

Ischium Diplod. same Skeleton as Sk. 3.

**Marsh writes to Felch that he has enclosed the check.**

Yale College Museum, New Haven, Conn.

Aug. 16<sup>th</sup>, 1887

Dear Mr. Felch

Enclosed find check as requested

Will write again soon.

Yours Truly  
O. C. Marsh

**Felch writes to Marsh that there is only one small area of possibility left for new bones of interest in the old quarry. If this fails, he feels they should go to Quarry No. 2 and work rather than go to the expense of stripping off more.**

Canon City, Colo.  
Aug. 23<sup>rd</sup>, 1887

Prof. Marsh  
Dear Sir

Yours with check came yesterday for which please accept our thanks.

Since my last we have found nothing of any special interest – and we are getting about discouraged with the outlook for I have been in hopes ere this to have found more of the big carnivore if not the skull.

Most all of the ground worked for the past three weeks the bones seem to be water worn and fragmentary – but as this ground is mostly outside of the regular bone bed we hope to find things better further to the left where we shall try next.

Unless we do make some good find by the time we get the present ground worked – that we have stripped off I do not believe it will pay to go in any further, for the expense of stripping off so much rock to get down to the bones will hardly pay the outlay.

I think we could find as good bones with half the expense across the gulch where Brown worked = Quarry No. 2 = for where he left off work he had just got in to a lot of good bones.

Enclosed find receipt for money sent.

Respectfully Yours  
M. P. Felch

Canon City, Colo.  
Aug. 23<sup>rd</sup>, 1887

\$170.<sup>00</sup>

Rec'd of Prof. O. C. Marsh one hundred and seventy dollars for work for U. S. Geo. Survey – for July 1887.

M. P. Felch

**Felch writes to Marsh about the unusually bad weather causing his crop damage and land loss on his farm. He is expecting vouchers but mails are having trouble getting through. He encloses a color coded diagram of continued work in Quarry 1 and he gives details of where the bones are being found and how they relate to Sk. 11. He is more encouraged with the new ground within the red line where he has sketched bones, and better weather that has just set in.**

Canon City, Colo.  
Sept. 4<sup>th</sup>, 1887

Prof. Marsh  
Dear Sir

I have been expecting for several days past to receive the vouchers for August – but as they have not come to date – I did not know but what they had been sent and miscarried – as the mails have been quite irregular on account of the severe storms between here and the Missouri river.

I have not written very fully of late in regard to work for several reasons.

August was a month full of drawbacks and discouragements – the storms showers – cloud bursts – hail storms were almost of daily occurrence – our crops suffered more than ever before – our lands were many times overflowed – and in some cases entirely carried away along the creek – I having during one night lost nearly an acre of my best bottom land – the roads to town were made impassible and some days we were entirely cut off from the quarry – and for days together as we could not keep foot logs in place we had to use our horses to ford the creek to get to and from our work in the quarry

To add to this – most of the entire month was spent in working ground that was almost worthless, as far as getting any specimens of interest or value – ground that had to be worked through as carefully as though full of good bones.

I enclose a map or outline showing where this ground is – also the ground stripped off after the June shipment and what we have left of this to work out

After stripping we began on the extreme south end – and found some good bones – a large femur and part of a tail of Diplodocus – also some other leg bones – foot bones etc.

Working back in this direction (North) we took out all of the section inside that marked in blue = middle portion = all of which proved to be worthless – the bones being broken – fragmentary and water worn.

One group here – a small one – coming in near the red  line, and on the front side, I have saved to send as a sample of this section – and this group is far above the average of the whole section.

This brings us up and into the section enclosed in red, where we have been at work during the past week.

Here we find the bones in two separate layers – the upper have some of the remains of an animal of immense size.

Of these we have the scapula & coracoid both whole and in first rate condition – also a leg bone which we have partly uncovered that I think may prove to be the largest one ever taken out of the quarry – and under and around this last there appear more cropping out of the same skeleton.

The bottom layer is continued on back from some of the groups taken out last year and from where we work the first part of this season – and the bones here are apparently in good condition and crowded in together as thick as we have ever found them any where

It is in this under layer and a little to the right of the line of Sk. 11 – that the forward part of the skeleton of the carnivore should be if it keeps its position as some of the lot shipped in June showed we had got up as far on the skeleton as the fore legs and coracoid.

On the whole the prospect which last month was so discouraging is now much better – we are having splendid weather which we think has come to stay awhile – we have a lots of good bones in sight in good ground – and altogether we hope and expect to have a change in luck soon

Respectfully Yours  
M. P. Felch

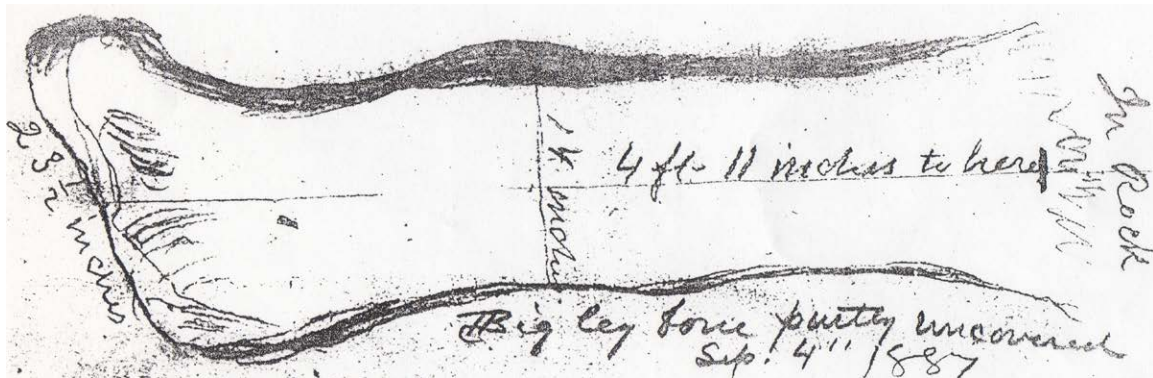

Rock  
4 ft. 11 inches to here    14 inches    23 ½ inches

Big leg bone partly uncovered  
Sep. 4<sup>th</sup>, 1887



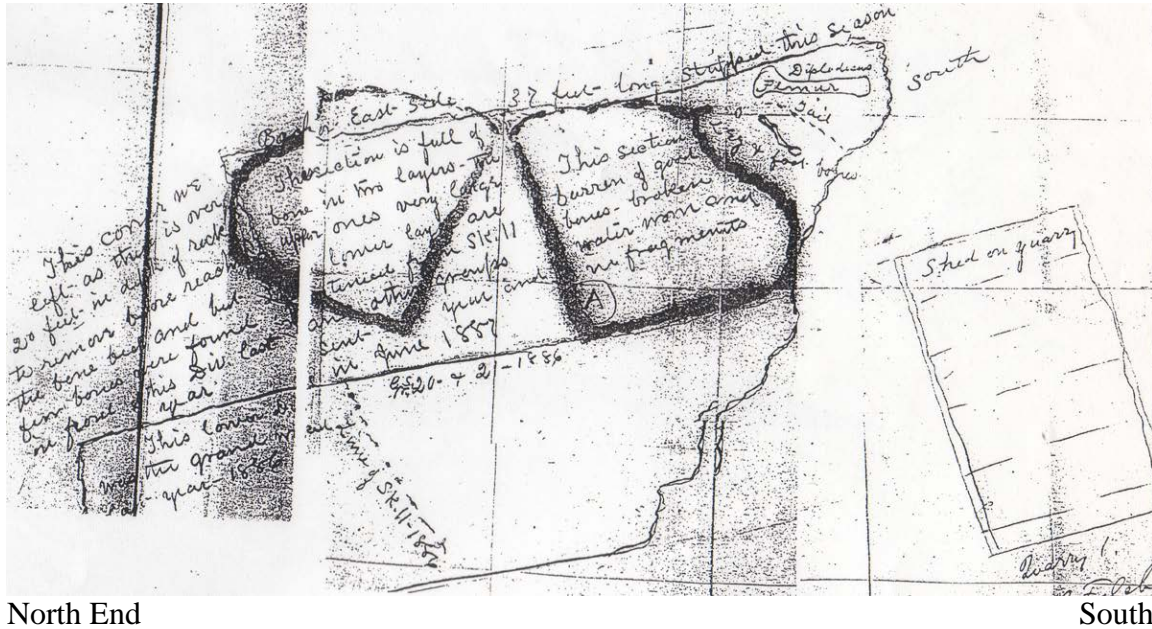

This corner we left as there is over 20 feet in depth of rock to remove before reaching the bone bed and but few bones were found in front of this Div. last year.

This lower D. was the ground worked last year 1886  
Line of Sk. 11 - 1886      Gr<sup>s</sup>. 20 & 21 - 1886

Back or East Side

The section is full of bone in two layers - the upper ones very large  
lower layer are continued from Sk. 11 and other groups sent last year and in June 1887

37 feet long - stripped this season

Diplodocus femur

tail

leg and foot bones



This section barren of good bones - broken water worn and in fragments

Shed on quarry

Quarry 1  
M. P. Felch  
Sept 4<sup>th</sup>, 1887

**Marsh writes to Felch that he has received the diagram and is glad he is in a good area again. Marsh hopes for the big carnivore head soon.**

Department of the Interior, United States Geological Survey  
Division of Vertebrate Paleontology

New Haven, Conn.,

Sept 9<sup>th</sup>, 1887

Dear Mr. Felch,

Yours of the 4<sup>th</sup> with diagrams has just come to hand, and I am glad to know you are once again among the good bones.

I am quite sure the vouchers for Aug were sent to you, but as they have not turned up I enclose duplicates which return soon.

I enclose a small check as you may need some funds.

Hope you will get that big Carnivore head soon.

In haste

Yours Truly

O. C. Marsh

**Felch writes to Marsh that he is not paid up on back accounts and needs more money than the \$50 sent as his daughter is going to California on Oct. 1. He writes about current work and comments that they find little of the large carnivore. He tells of his son finding turkey tracks and mule tracks in middle (yellow) cretaceous rock. Felch would like, "as this is in a neighborhood where some of the earlier mammals ought to be found I want to put in one season if I live in exploring the ground".**

Canon City, Colo.  
Sept. 14<sup>th</sup>, 1887

Prof. Marsh  
Dear Sir

Yours of the 7<sup>th</sup> with Aug. vouchers and check for \$50. came yesterday

It seems you have forgotten what I wrote in regard to the vouchers and back accounts but I will let that go for the present and have it fixed up on the final settlement.

If you can send me the balance on Aug. account = one hundred dollars = so that I can get it by the 30<sup>th</sup> of this month I can get along but my daughter expects to go to California Oct. 1<sup>st</sup> and I shall want all I can get then.

We are getting along first-rate find lots of bones – that come out well and generally in better condition than those taken out last year.

We have now worked in – on the under layer – back of where the last of Sk. 11 was found but have seen nothing more of it – all the bones here belonging to the carnivorous beast and to some of the larger Sauropoda.

One thing seems strange in regard to the Skeleton of the Carnivore is – that though we find plenty of leg bones – one coracoid – lots of hollow foot bones, ribs etc. we find but very few vertebrae either caudal or dorsal that belong to it – still they may be more or less hidden in the big blocks.

Some of these foot bones have calcite in them almost like pearl.

We have some distance yet before reaching the back wall on the line of the carnivore – and are in hopes to find his head before getting there – but if we do not shall feel like giving up trying and strike out for a new field and something different.

My son was out stock hunting a few days since, and in the sand rock of the middle (yellow) cretaceous found a lot of turkey tracks – and mule tracks – or rather some impressions made in mud before it turned to rock – and as this is in a neighborhood where some of the earlier mammals ought to be found I want to put in one season if I live in exploring the ground.

Resp. M. P. Felch

**Marsh states that he will look up a letter of last summer and arrange matters.**

Department of the Interior, U. S. Geological Survey  
~~Washington, D. C.~~, New Haven Ct.

Sept 19<sup>th</sup>, 1887

Dear Mr. Felch,

Yours with vouchers is at hand. Enclosed find check for \$100. as requested.

Will look up your letter sent last summer, and arrange matters. Have been away for some time.

Glad you are having such good luck.

Yours Truly  
O. C. Marsh

**Felch writes to Marsh that he is coming to the conclusion that Quarry No. 1 is about “petered out”. There may be more under the hill but “reclaiming them is too much of an undertaking –even if we knew them to be there”. He discusses the best part of the quarry they have now completed which resembles a “mire hole-where so many animals got stuck”. Unless prospects change they are ready to pack up on Quarry 1.**

Canon City, Colo.  
Oct. 1<sup>st</sup>, 1887

Prof. Marsh  
Dear Sir

Yours with check for \$100. = bal. on Aug. account = came last week – and I should have answered sooner but a cold rain came up quite sudden – we had a good deal of material out on the quarry and it kept us all busy to take care of it and make all safe.

I hardly know what to say about the work, and prospect ahead – but have about come to the conclusion that our old quarry, that has produced so many of good – bad & indifferent specimens – is about “petered out”.

There may be many good skeletons yet away in further under the hill but the work of reclaiming them is too much of an undertaking – even if we knew them to be there.

I thought three weeks ago that the show was as good as ever, but as we go on east – we have to leave that deep depression which runs diagonally into the hill = north of east = and in which all of our best specimens have come from – and in this ground the bones though plenty in places are badly broken and worn – the strata in which they lay is thin – full of rocks and pebbles without any well-defined seams to work by – and the whole appearance goes to show – these were out of the mire hole – where so many animals got stuck – and what we have now is but stray and scattered fragments brought in by the wash and drift.

I have been a good deal disappointed for I certainly thought we should find one or two skulls here anyway to go with so many other bones – and when the indications were so good but I am afraid we shall have to give it up – for we have not much more ground stripped to find them in.

I think two or three weeks more of good weather, will finish up all we can do to advantage and unless the prospect changes a good deal for the better we had better pack up and quit on “Quarry No. 1”

I have done no boxing yet for the reason that it is impossible to get up lumber from town – the roads are in such terrible condition.

It is all a team can do to take in an empty wagon – up our canon – but we expect to have them put in repair before winter sets in.

Please send on the vouchers for Sept. soon.

Transcribed at the Garden Park Paleontology Society's Dinosaur Depot Museum, Cañon City, Colorado.  
Original material housed at the Marriott Library, Special Collections Division; University of Utah, Salt Lake City.

Respectfully Yours  
M. P. Felch

**Marsh writes to Felch that he has sent vouchers and hopes the good luck continues.**

Department of the Interior, United States Geological Survey,  
~~Washington, D. C.~~, New Haven

Oct 6<sup>th</sup>, 1887.

Dear Mr. Felch,

I enclose voucher for Sept. as you requested.

I have been away or I should have sent them before.

Hope your luck continues

Yours Truly  
O. C. Marsh

**Felch writes to Marsh that he received the vouchers.**

Canon City, Colo.  
Oct. 11<sup>th</sup>, 1887

Prof. Marsh  
Dear Sir

I came in town this morning, and find yours with vouchers for Sept. which I return signed.

Will write soon.

Respectfully Yours  
M. P. Felch



**Felch writes to Marsh stating that they are not having good luck and Marsh must not have read his last letters carefully. He says that the best finds have always been in the depression, which is the old river bed which is completely cleared. He feels better bones are available for less effort and expense across the gulch.**

Canon City, Colo.  
Oct. 16<sup>th</sup>, 1887

Prof. Marsh  
Dear Sir

In reading over your last two letters I infer you could not have read my late letters very carefully or you would have seen that I did not consider we were having very "good luck" – as only once if I remember right for the past two months have I thought we had struck anything of interest.

The fact is – as I stated some three weeks since – that appearances indicate and work proves that in one direction at least the good bones are worked out – and that we are off from the "pay streak".

I suppose you remember that there was quite a depression running about north-east and south west – and in this depression which we call the old river bed – we have always found our best and most perfect specimens.

As this run in a diagonal manner with the front of our working ground – we gradually cut across, and by it as we worked east, until our last stripping this year took us most altogether east of it -, and out of the region of good bones – most all of our find being broken – water worn and fragmentary.

There is any amount of stuff such as it is – but of late I do not know of anything that is going to be of much account.

It is true we can tell but little of what there is when taken out in blocks – but we are quite sure there is no continuous skeleton.

Now what to do about working more of this ground – after we get done what there is stripped off – I want you to decide upon for I do not like to take the responsibility of going to work to strip off any more ground of this kind when the expense is so great – for I think there are better bones that can be obtained with far less trouble and expense – only just across the gulch.

It will take me a month or so more to close up the work and in the meantime – would like to have you write me about what to do.

Respectfully Yours  
M. P. Felch

P.S. Please remit if convenient so that I can get it by the last of the month – as I have quite a number of bills to pay then.

Transcribed at the Garden Park Paleontology Society's Dinosaur Depot Museum, Cañon City, Colorado.  
Original material housed at the Marriott Library, Special Collections Division; University of Utah, Salt Lake City.

M. P. F.

**Marsh writes to Felch that he has been gone, encloses a check and will settle accounts when he closes work. Luck is running out.**

Department of the Interior, United States Geological Survey  
Division of Vertebrate Paleontology

New Haven, Conn.,

Oct. 28<sup>th</sup>, 1887,

Dear Mr. Felch,

I have been away so much of late, and so overwhelmed with work that I have not had time to go over your late letters to see just how our account stands. I send a check now as you request, and when you close work we will arrange matters for the season.

I am very sorry you have had bad luck with the old quarry, but think next season will bring some good skulls.

Yours Very Truly  
O. C. Marsh

**Marsh writes to Felch that he is sorry the quarry seems to be petering out and hopes for more luck.**

Department of the Interior, United States Geological Survey  
Division of Vertebrate Paleontology

New Haven, Conn.,

Nov 5<sup>th</sup>, 1887

Dear Mr. Felch,

Enclosed find vouchers for Oct. which please return soon. I hope you have by this time found something better as those waterworn bones can be of little value.

I shall be very sorry if Quarry 1 has really petered out as I wanted another Carnivore skull from there very much

How about the West end where you left part of a skeleton?

Yours Truly  
O. C. Marsh

**Felch writes to Marsh about payments and closing for the season. He will ship the boxes once the road is repaired, others expect him to do more than his share as he has the last few years but he does not plan on more than his fair share. He and his men prospected and have found two more areas of interest for future work. One is an area previously worked by Lucas to the east and the other is the quarry across the gulch, worked by Brown where he says there is a carnivore.**

Canon City, Colo.  
Nov. 7<sup>th</sup>, 1887

Prof. Marsh  
Dear Sir

Yours of Oct. 28<sup>th</sup> with check I did not receive 'till to-day – had begun to fear that it might have been sent on and was lost.

Enclosed please find receipt for the same.

I have got so far behind in some of my payments – hired help to pay off for the season on my ranch and other bills – that this will not go round and as my man who has been with me all summer wishes to leave for the Gunnison Country on or about the 25<sup>th</sup> I shall need another remittance by that date. If it would suit you as well you might make out the Oct. payment in two installments – one of a hundred payable Nov. 20<sup>th</sup> and the bal. any time up to Dec. 10<sup>th</sup> as there will be about 100 due my man who has helped me on the quarry this season when he quits work.

In the meantime you can send on the vouchers for Oct. for whatever will make you safe in advancing the money.

I can get everything closed up this month I think but may not be able to ship before the middle or last of next month on account of the roads which are yet in an almost impassible condition – and all hands are waiting for me as usual to do the principal amount of the work done, as they think I am obliged to do it in order to remove the boxes – but I think this year they will be somewhat disappointed – for I will haul them down through the parks on a sled before I will do any more than my amount of road work, as I have been doing for three or four years past.

During the late cold snap when it was too rough to do much on the quarry we done a little prospecting to see if we could find any better outlook for bones than in our old diggings, and found two places – one about  $\frac{3}{4}$  of a mile east of our residence – where Lucas done some work a few years since – and I am inclined to think from appearances that when fully opened up, some good specimens might be found, without going so deep – or having to do so much work to get at them as in our old quarry.

We know that where Fred – Brown left off work on the flat opposite our quarry that he left a lot of good bones – and that quite a portion of a Carnivorous Dinosaur similar to Allosaurus was left there and there is no place on that side of the gulch where the bones are buried more than 6 or 7 feet deep

If we do any work another year – we want to do it where the results are more satisfactory than they have been this.

Very Respectfully  
M. P. Felch

Canon City Colo.  
Nov. 7<sup>th</sup>, 1887

\$170.<sup>00</sup>

Received of Prof. O. C. Marsh one hundred and seventy dollars self – team & outfit - for collecting fossils for the month of Sept. 1887

M. P. Felch

**Felch writes to Marsh that they will work a bit in the West End, looking for the Allosaurus skull and will put in his own time in another location if unsuccessful there. He has visited the turkey track site found by his son and gives information on its location and appearance.**

Canon City, Colo.  
Nov. 14<sup>th</sup>, 1887

Prof. Marsh,  
Dear Sir,

Yours with Oct. vouchers came in due season – and you will find them duly signed, and returned with this.

After we get the rest of the work done, if the weather permits we will put in a few days this fall – back toward the “west end” – in the vicinity of where the skeleton of Allosaurus lay, to see if we can find anything of the skull due from that individual.

We have been greatly disappointed in not finding the head of the big carnivore – when all the indications and prospects were so good at one time.

If we do not find one in the “West End” I will put in two weeks in another place, at my own expense, and not charge up the work – unless we are fortunate enough to find one.  
I visited yesterday (Sunday) the place where my son found the turkey tracks in rock some time since.

The locality is about one mile east of the road as we go in to Canon City and about 4 miles from where we live. During the past few years the heavy rains have uncovered a ledge of rock inclined some 15 to 20 degrees – on the smooth surface – of which are what have all the appearance of large bird tracks – thousands of them – and crowded together so thick as to be impossible to trace out any one individual. There are other tracks having the appearance as if made by a sharp hoof – a third wider than long – some of them ten inches wide. The rocks are in regular position – under the heavy lime rock, and near the base of No. 2 Cretaceous

The fossils seen are bi-valves small and large – with lots of shark teeth and some teeth that resemble those of the smaller Carnivorous Dinosaurs. Could there have been at that period any animal with so large a hoof?

Respectfully Yours  
M. P. Felch

P.S. I find that I am entirely out of the Official Envelopes – also blanks for requisition on the Qr. Master for Bills of Lading.  
M. P. F.

**Marsh writes to Felch that he is to send the fossils 4<sup>th</sup> class freight. He mentions the bird tracks as possibly important. He thinks they may be dinosaur and Felch had better not say much about them.**

Department of the Interior, United States Geological Survey  
Division of Vertebrate Paleontology

New Haven, Conn.,

Nov 19<sup>th</sup>, 1887

Dear Mr. Felch,

Yours of the 14<sup>th</sup> is at hand. I enclose check for \$150. and will send balance when you close work.

I also send envelopes etc. as you request.

Be sure and have fossils go as 4<sup>th</sup> class freight.

I am much interested in those "Bird tracks" you describe, and wish you had secured one or two, with one of the larger tracks. The latter cannot be Mammalian if the beds are Cretaceous. Better not say much about them as they may be important.

I should think the large tracks as well as the small ones were made by Dinosaurs.

Yours Truly  
O. C. Marsh



**Felch writes to Marsh that the weather has been extremely snowy and cold but is improving enough to box up what they have taken out. The A. T. & S. F. will very soon have direct shipping from Cañon City (no Pueblo transfer) so he will wait to ship the boxes until then. He gives more specific information on the turkey track locality including strata.**

[At the top of the page is a clipping from the Cañon City paper that partly obscures the heading.]

“The last part of November tried to make a fair balance in the temperature of the month. Up to the 22<sup>nd</sup> day of November the weather was almost like summer without storm or cloud. From the 22<sup>nd</sup> to the 26<sup>th</sup> it was cloudy, snowy and chilly and on Sunday morning the mercury got down 7° below zero, and it remained cold till the 29<sup>th</sup>. The cold extended over a large section of the western country and was unusually severe for November. At Denver it was from 15° to 20° below and in Montana the mercury ran out of sight.”

Colo.  
Dec. 2<sup>nd</sup>, 1887

Prof. Marsh  
Dear Sir

I rec'd your check. and wrote in answer over a week since, but by some mistake the letter was overlooked and not mailed – and I did not discover it until yesterday.

We had to close down work last week on account of the most severe storm that we ever saw at this time of year – snow falling over a foot deep, and the mercury to from 10 to 20 degrees below zero, making it impossible to work at all on the quarry.

It has come off warm again – and most of the snow has gone, but it is so late in the season – that all I shall do will be to get what we have, boxed up and shipped off.

I think I can do this in ten days or two weeks but as the A. T. & S. F. Railway have got their extension to Canon City almost completed – and will be ready to ship freight direct from this point by the 20<sup>th</sup> or 25<sup>th</sup> of this month, I will wait until then so as to save the transfer at Pueblo as formerly.

In regard to those tracks in the rocks, the place is so much out of the way – that but few would take the trouble to visit the locality – and those who know of them take but little interest in the matter.

The impressions are found in the top of a certain brown sandstone strata a little below the greyish white, marine limestone of No. 2 Cretaceous.

In this same sandstone, you pointed out a mass from this strata, from which you obtained some oyster shells on your first trip here several years since – down on the road to Canon.

Enclosed please find receipt.

Transcribed at the Garden Park Paleontology Society's Dinosaur Depot Museum, Cañon City, Colorado.  
Original material housed at the Marriott Library, Special Collections Division; University of Utah, Salt Lake City.

Respectfully Yours  
M. P. Felch

Canon City, Colo.  
Nov. 25<sup>th</sup>, 1887

\$150.<sup>00</sup>

Received of Prof. O. C. Marsh, the sum of one hundred, and fifty dollars – on Act. for collecting fossils to Oct. 31<sup>st</sup>, 1887.

M. P. Felch

**Felch writes to Marsh that he is ready to ship over twenty boxes though some material is worthless and may not ship that. He asks for Marsh's decision.**

Canon City, Colo.  
Dec. 19<sup>th</sup>, 1887

Prof. Marsh  
Dear Sir

I have got all but one or two of the boxes ready to ship, some over twenty in all I think.

I could fill several more boxes by taking in some of the last lot taken out, but this is so broken and disconnected, that I have hesitated about going to the expense of sending it – as it costs a good deal for boxing and other material, lumber, such as I have to use in making boxes costs me \$35. Pr. M. in Canon, besides the hauling over bad roads.

I will look over the last group that we took out again, and if I think it is not entirely worthless – will fix it up so send on with the balance if you think best.

I shall have plenty of time to do this as the Santa Fe folks will not be ready to receive freight till the first week in January – and it will have to go on that road.

I have not received the vouchers for Nov. and suppose you must have forgotten or overlooked the matter – and as it is getting so near the close of this month – it might be well enough to have them all sent on at once – or have the two months included in one set of vouchers.

Respectfully Yours  
M. P. Felch

See P.S. Opposite  
P.S. I will say that in view of the fact that we have not had the best of luck this season – that I shall only charge for half a month's work (\$75) from Dec. 1 up to the time all of the boxes are shipped.

If my account is correct there was due me Dec. 1<sup>st</sup> 175 dollars – 25 of the 50 having been paid

This will bring me out about square – and it is all I care for – and hope that if I do any more work in the future it will be more satisfactory to myself at least.

Truly Yours  
M. P. Felch

(\$100. sent Dec 26<sup>th</sup>, 1887) [Note at bottom of page in another hand.]

**Marsh writes to Felch that he is working on Jurassic dinosaurs from just outside of Washington, D. C.**

Department of the Interior, U. S. Geological survey  
~~Washington, D. C.~~, New Haven

Dec 26<sup>th</sup>, 1887

Dear Mr. Felch,

Yours of the 19<sup>th</sup> came today. I was waiting to know whole amount due before sending vouchers.

These I now send as you suggest for two months, to cover the amount due you, as per account sent.

I am hard at work on a new lot of Jurassic Dinosaurs from just outside Washington D. C. They have been lying around loose there for ages, while the "fireside geologists" there have been busy asserting that the beds contain nothing. Will send you my paper soon. One of the Sauropoda is only about 12 ft long.

I enclose check for one hundred dollars as you may need it.

Yours Truly  
O. C. Marsh